

NOTE:

1. ALL DIMENSIONS ARE REFERENCE ONLY.
2. DIMENSIONS IN PARENTHESES ARE METRIC.
3. THE ** DENOTE COLOR.
4. DUCT AND COVER ARE AVAILABLE IN 6 FT (1828.6) LENGTH.
5. PANDUIT DRDSF PLASTIC SCREW FASTENERS INCLUDED TO FASTEN USER SUPPLIED DIN RAIL TO DRD BASE.
6. LOCATING RIBS COMPATIBLE WITH 15 OR 35 mm DIN RAIL.

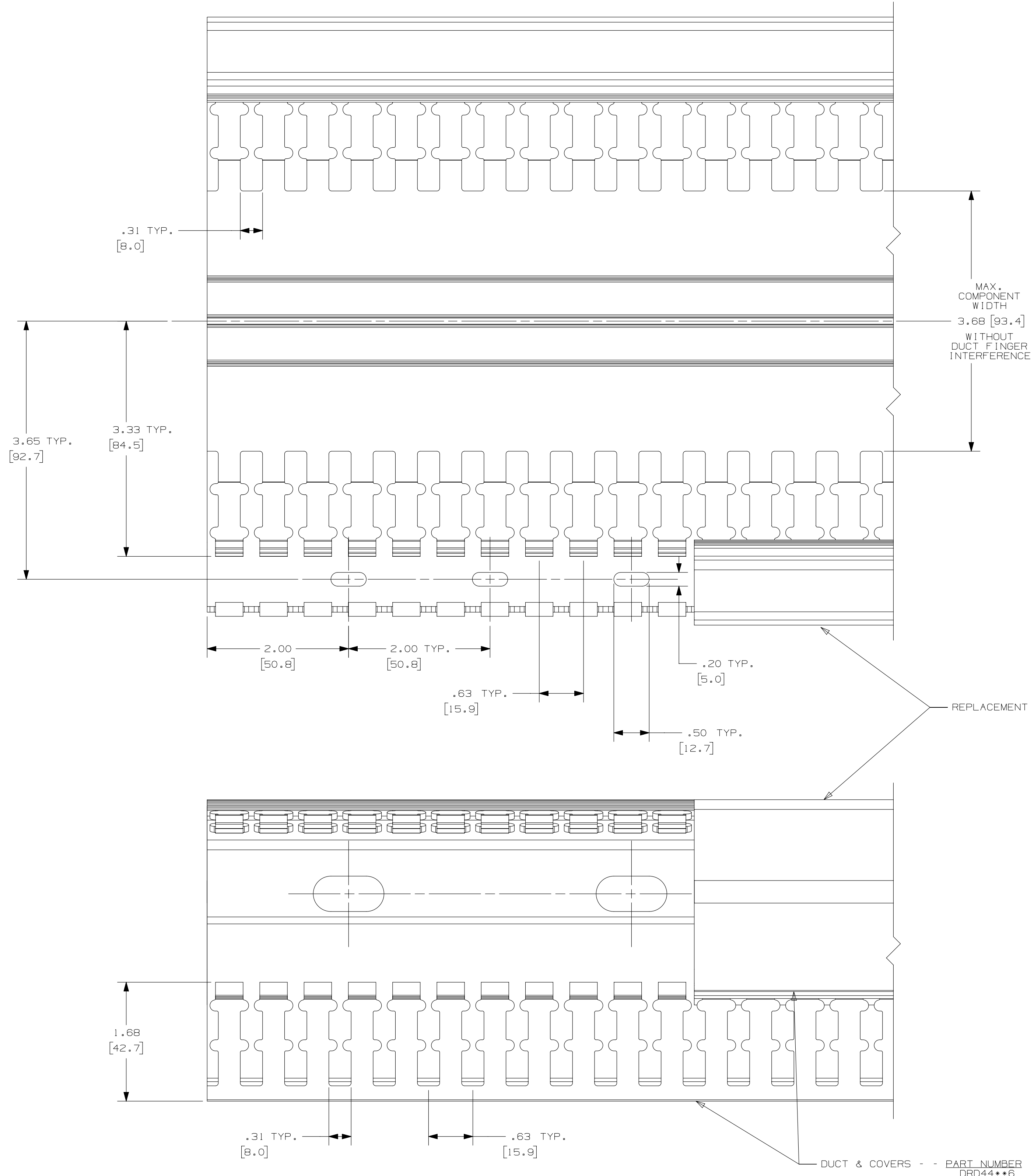
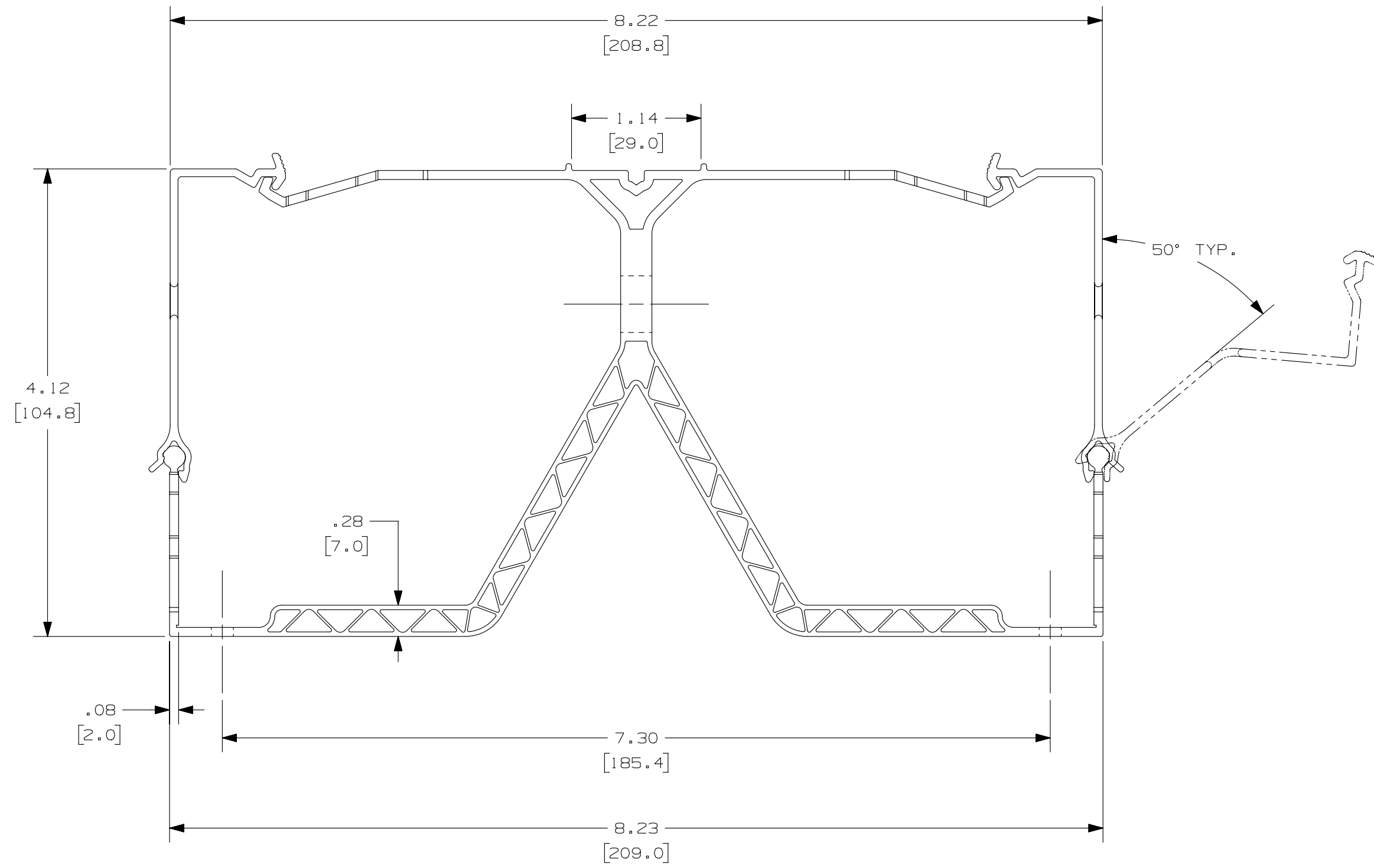

REV	DATE	BY	CHK	APR	DESCRIPTION	ECN
5	08.03.14	BDK	MRJS	JADE	J. DRAWING REVISION 4 ITEM G SHOULD STATE "UPDATED PROFILE TO NEW DESIGN"	36897-1251

TITLE		WIRING DUCT - TYPE DRD44 DIN RAIL DUCT WITH COVER	
ITEM REVISION NAME		D11000VL/03	
MARKETING DRAWING			
DATASET FILE NAME		D11000VL_DC/038	
UNLESS OTHERWISE SPECIFIED, DIMENSIONAL TOLERANCES ARE: (IN 1 mm)		PANDUIT	
.XX ±		PVC	
.XX ±		DRAWING NUMBER: 36897-1251	
THIRD ANGLE PROJECTION		SHT 1 OF 1	
DRAWN BY	DATE	CHK	SCALE
JCST	06-16-08	MKBE	FULL